



Designer Series Accent Frame Installation Guide

Horizontal Mount

Step 1

Level and mount bracket to wall.
(Mount into a stud for best results.)

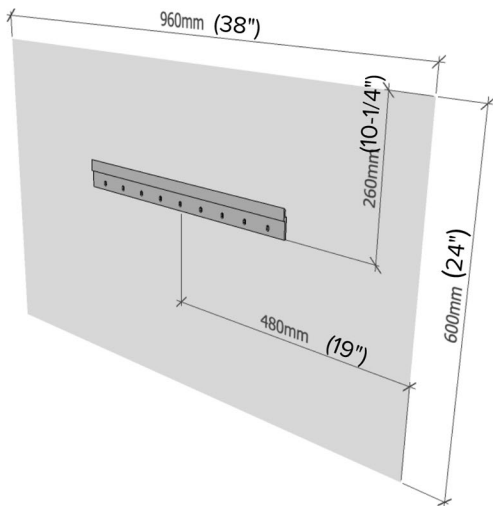

Step 2

Attach tray board to the mounted bracket.

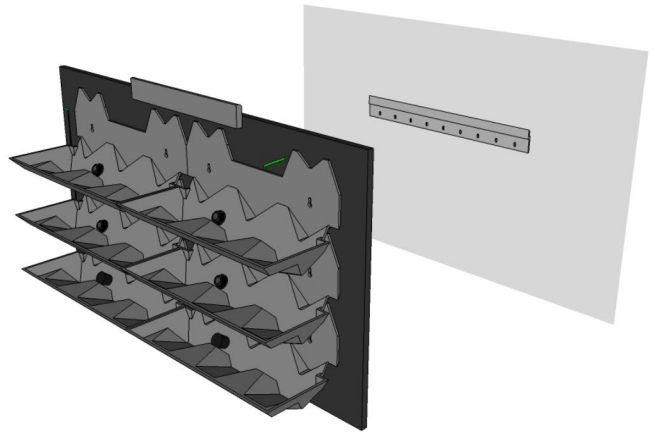

Step 3

Attach outer frame to tray board.

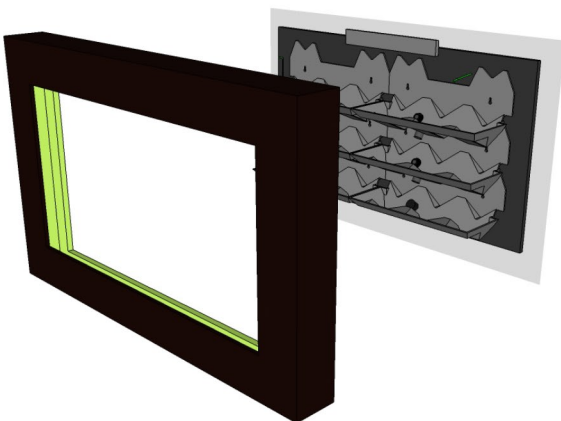

Step 4

Insert eighteen 4" potted plants into the pot holders.

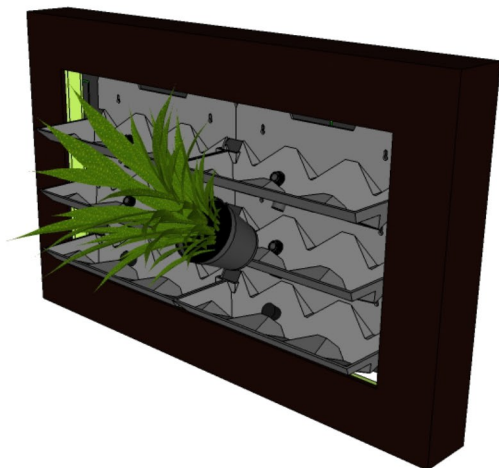



Designer Series Accent Frame Installation Guide

Vertical Mount Prep

Tray layout Prep 1

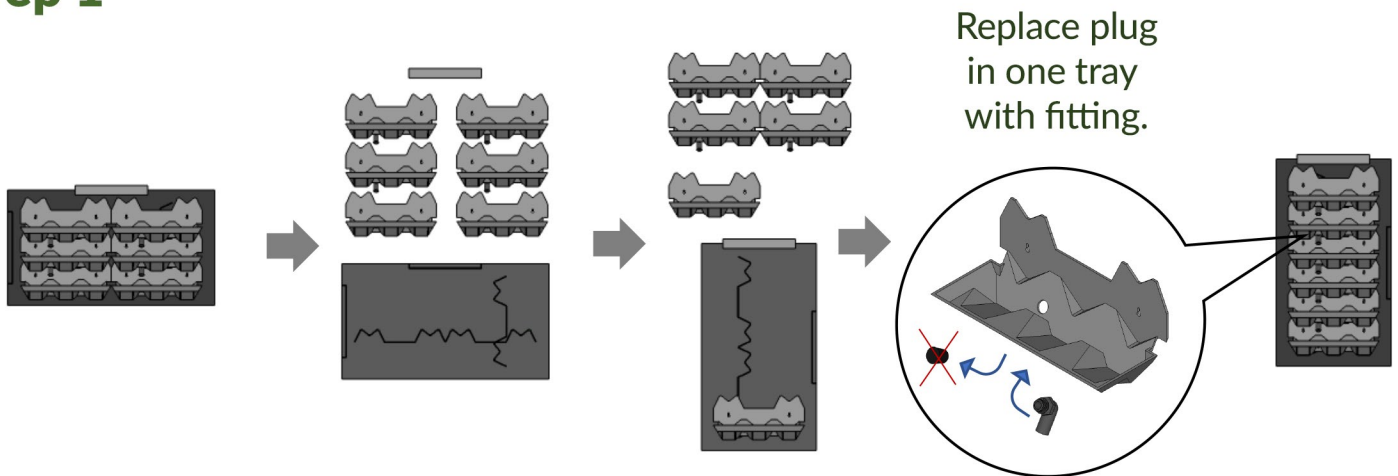

Mounting clip layout Prep 2

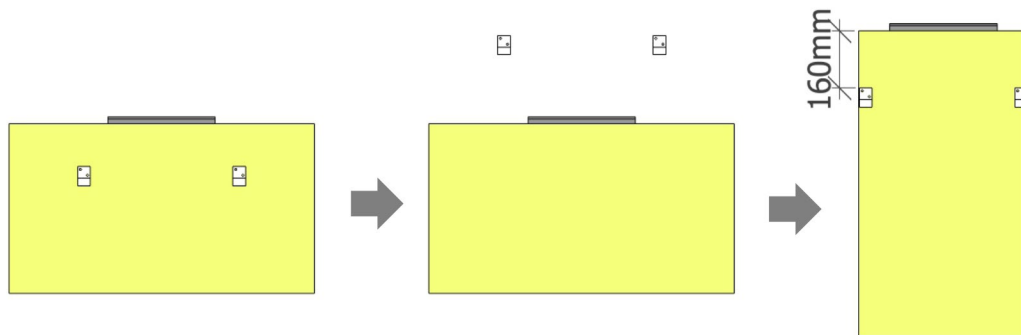



Designer Series Accent Frame Installation Guide

Vertical Mount

Step 1

Level and mount bracket to wall.
(Mount into a stud for best results.)

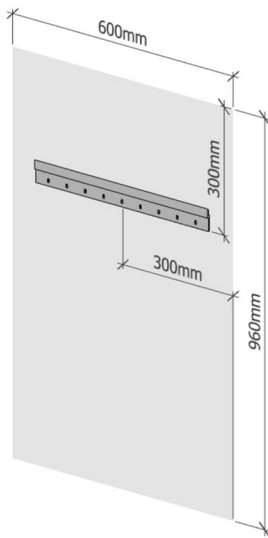

Step 2

Attach tray board to the mounted bracket.

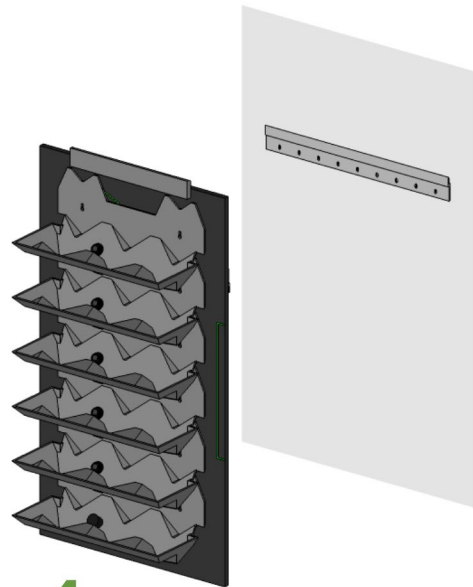

Step 3

Attach outer frame to tray board.

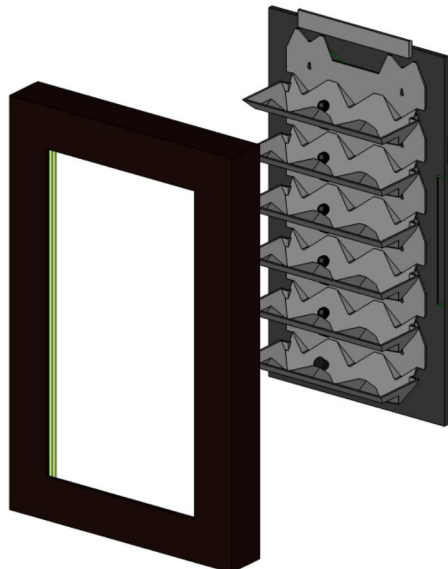

Step 4

Insert eighteen 4" potted plants into the pot holders.

